

RoHS

| REV. | DESCRIPTION | DATE |
|------|-------------|---------|
| A | | 01-2013 |
| | | |

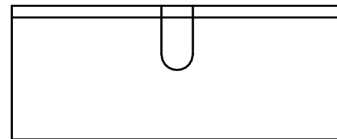
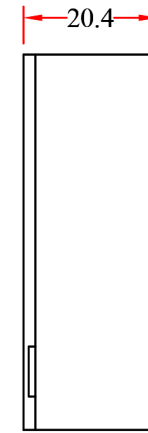
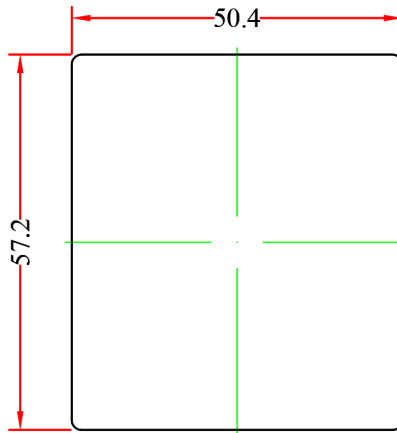
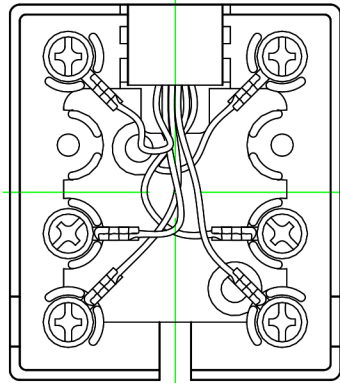
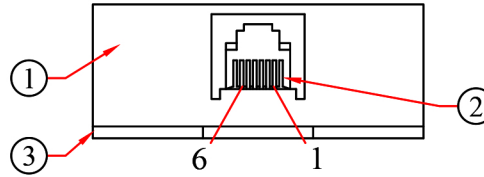

| Pin Assignment | |
|----------------|--------|
| 1. | White |
| 2. | Black |
| 3. | Red |
| 4. | Green |
| 5. | Yellow |
| 6. | Blue |

| | COLOR |
|--|-------|
| | Ivory |
| | White |

| | | | |
|-------------|---|----------|----|
| Part No: | 15-100-032 WH | DRAWER | |
| TITLE | RJ12 6 Conductor Surface Mount Box- Screw Terminal- 1 Port- White | CHECKED | |
| | | APPROVED | |
| MATERIAL | | SCALE | |
| REV. | A | UNIT | MM |
| DRAWING NO: | | | |

| | |
|-----|--|
| 3 | Double-Sided Adhesive Pad,Foam Plastic ,L 50*W40 mm |
| 2 | Screw ,ZnCr2- Plated |
| 1 | 26AWG(7/0.16 BC) Wire,Body ABS, Terminal Brass/Gold Plated |
| NO. | SPECIFICATIONS |
| | BOM LIST |